



»FAKTOR« 5  
»FAKTOR« 5.5



SPECIAL APPLICATIONS



# EXTREMELY EFFICIENT USED ALL OVER THE WORLD

Especially when transporting extremely heavy loads such as transformers, generators or other industrial components, high girder bridges are frequently in demand and to constantly demonstrate their full capacity in difficult infrastructures e.g. on bridges and other load-sensitive subsoils. Goldhofer's high girder bridges have been tried and tested worldwide and always guarantee a very good payload-to-dead weight ratio as well as maximum safety.

# »FAKTOR« 5 »FAKTOR« 5.5 FOR THE HEAVIEST LOADS

## YOUR BENEFITS

- ✓ Unique ratio between payload and dead weight
- » Compact transport system customized to utilization conditions
- ✓ Tried and tested, safe transport solution
- » High availability even under the most extreme conditions
- ✓ Simple mobilization and shipping
- » Economic delivery to the desired location

## TECHNICAL FEATURES

	»FAKTOR« 5	»FAKTOR« 5.5
+ Payload <i>(depending on combination)</i>	500 t	350 t
+ Lift height	1.80 m	1.60 m
+ Load widths	3.00-6.75 m	2.00-6.00 m
+ Load lengths	11.00-17.00 m	11.00-17.00 m
+ Axle configurations*	2x 12 AL to 2x 20 AL	2x 10 AL to 2x 16 AL
+ Beam	lateral beam, vessel bridge	

\* Thereby payload alteration

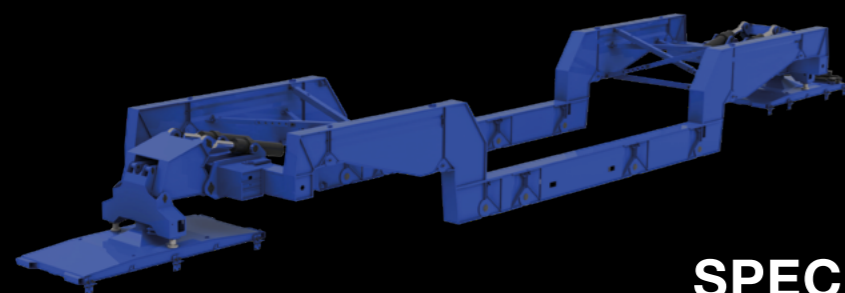

## SPECIAL APPLICATIONS



## USED ALL OVER THE WORLD

Transport specialists around the world rely on our high girder bridges. While we set new benchmarks with our technology, you can therefore rely on the fact that your bridge is the decisive »FAKTOR« for a successful and safe transport for any load.



## HIGHEST-POSSIBLE EFFICIENCY

The large lift provided by the loading bridge also makes it possible to pass under low route sections. The axle compensation of our heavy-duty modules simultaneously ensures that uneven terrain does not represent a challenge for transportation anymore.



## FLEXIBLY COMBINABLE

Our high girder bridges provide different beam configurations as well as various vehicle combinations in order to adapt ideally to the respective load. This ensures that you can transport the largest possible payload at the lowest possible dead weight at any time.



## »FAKTOR« 5 | »FAKTOR« 5.5

### TECHNICAL DATA

	»FAKTOR« 5	»FAKTOR« 5.5
Payload <i>(depending on combination)</i>	500 t	350 t
Lift height	1,80 m	1,60 m
Load widths	3,00-6,75 m	2,00-6,00 m
Load lengths	11,00-17,00 m	11,00-17,00 m
Axle configurations*	2x12-2x20	2x10-2x16
<b>BEAM</b>	Lateral beam, vessel bridge	

\* Thereby payload alteration

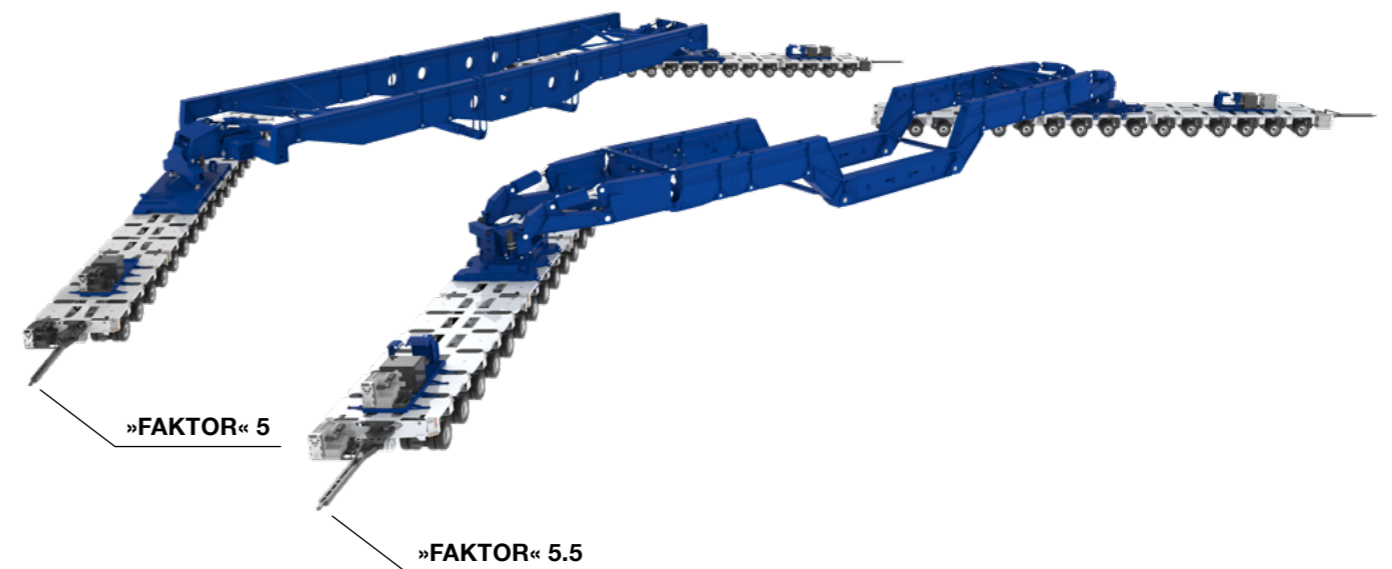



## CONTACT TRANSPORT TECHNOLOGY

### GOLDHOFER AKTIENGESELLSCHAFT

---

Donaustrasse 95, 87700 Memmingen/Germany  
Tel.: +49 8331 15-0, Fax: +49 8331 15-239  
Web: [www.goldhofer.com](http://www.goldhofer.com), E-Mail: [info@goldhofer.com](mailto:info@goldhofer.com)

### SALES

---

Telephone Sales Europe: +49 8331 15-341  
Telephone Sales International: +49 8331 15-342  
E-Mail: [sales-transporttechnology@goldhofer.com](mailto:sales-transporttechnology@goldhofer.com)

### SERVICES AND SPARE PARTS

---

Telephone: +49 8331 15-400, Fax: +49 8331 15-247  
Emergency Hotline: +49 172 837 61 65  
E-Mail: [service-transporttechnology@goldhofer.com](mailto:service-transporttechnology@goldhofer.com)