

Goldhofer

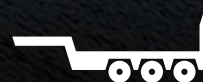

»MPA« | STZ-L/-H
»ARCUS« P / PK



SEMI LOWLOADERS

OUR SEMI LOWLOADER CREATED TO MASTER CHALLENGES

Construction machinery, plant components, crane segments - just a small selection of what our STZ-L, STZ-H, »MPA« and »ARCUS« series semi-trailers move safely and reliably on a daily basis. No matter what load awaits you, our vehicles master every challenge effortlessly.



STZ-L | STZ-H | »MPA« PREPARED TO FACE EVERY TASK

Regardless of when you need a versatile vehicle, our STZ-L, STZ-H and »MPA« semi lowloaders are your first choice. With the same vehicle bodywork, different axle units can provide you with exactly what you require for your applications: low loading height, extraordinary axle compensation or maximum robustness.



10

STZ-L | »MPA« WITH WHEEL RECESS FLEXIBILITY IS WHAT COUNTS

Our forced-steered wheel recessed vehicles are flexible workhorses in which you can individually utilize the loading area to also transport high loads with low overall heights. Extensive accessories and options round off the product range for these application-oriented and powerful helpers for everyday transport duties.



12

»ARCUS« P / PK THE ALL-PURPOSE WEAPON

Our semi lowloaders of the »ARCUS« family are real workhorses - there is nothing they cannot handle in the payload class up to 130 t. The »ARCUS« family impresses with an innovative steering system. In combination with the extremely low loading height of just 735 mm*, it provides you with the decisive advantage in terms of maneuverability, performance and efficiency.



14



CARGOPLUS

The »CARGOPLUS« low-profile tires developed by Goldhofer offer the twin advantages of higher payloads and lower loading heights.

»CARGOPLUS« 60 supports axle loads of 10 tons compared with 8 tons with 205 tires, while »CARGOPLUS« 80 corresponds to 245 tires and delivers a 75 mm reduction in loading height for the same axle load of 12 t at a speed of 80 km/h. This translates into the ability to move taller and heavier construction machinery, which in turn means greater versatility, more flexibility and fewer detours due to height restrictions on the route. The tires have been extensively tested to ensure a high level of reliability for reduced operating costs and increased efficiency.

| AXLES | 205/65 R17.5 | LOADING HEIGHT | 245/70 R17.5 | LOADING HEIGHT | 225/60 R17.5 »CARGOPLUS« 80 | LOADING HEIGHT |
|----------------|------------------|----------------|------------------|----------------|--------------------------------|----------------|
| 1 | 8.000 kg* | | 10.000 kg | | 10.000 kg | |
| 2 | 8.000 kg | | 10.000 kg | | 10.000 kg | |
| 3 | 8.000 kg | 710 mm | 10.000 kg | 785 mm | 10.000 kg | 710 mm** |
| 4 | 8.000 kg | | 10.000 kg | | 10.000 kg | |
| 5 | 8.000 kg | | - | | - | |
| PAYLOAD | 40.000 kg | | 40.000 kg | | 40.000 kg | |

»CARGOPLUS« 80 (225/60 R 17.5)

- »ARCUS« P
- »STEPSTAR« N
- »STEPSTAR« Z
- »TRAILSTAR«
- STZ-L / STZ-H

AXLE LOAD 10 t / 12 t vs. 8 t
LOADING HEIGHT 710 mm vs. 785 mm (245/70 R 17.5)



OUR MULTITALENTS FOR EVERY LOAD

The semi-trailers in the STZ-L, STZ-H and »MPA« series impress with their sophisticated axle technology and user-friendly operation. With these economical vehicles, you are equipped for any challenge.



WHEEL RECESSED VEHICLES

Even more flexibility during transport: Utilizing wheel recesses makes the use of the loading area even more flexible and your transport will become even more economical.

MORE ABOUT THE
TYPE STZ-L/»MPA«
WITH WHEEL RECESS

PAGE
12

KNUCKLE TYPE STEERING AXLE WITH AIR SUSPENSION

The tried and tested axle technology with components from renowned manufacturers ensures a longer service life and high cost-effectiveness.

» Maximum steering angle 45°

STANDARD TIRES

- » Axle stroke 200 mm
- » Loading height 785 mm

»CARGOPLUS«

- » Axle stroke 190 mm
- » Loading height 710 mm



KNUCKLE TYPE STEERING AXLE WITH HYDRAULIC AXLE COMPENSATION

This robust axle technology enables a longer service life and high vehicle availability. The axle stroke is operated hydraulically and guarantees high lateral stability with large and heavy loads.

- » Maximum steering angle 45°
- » Axle stroke 260 mm
- » Loading height 800 mm

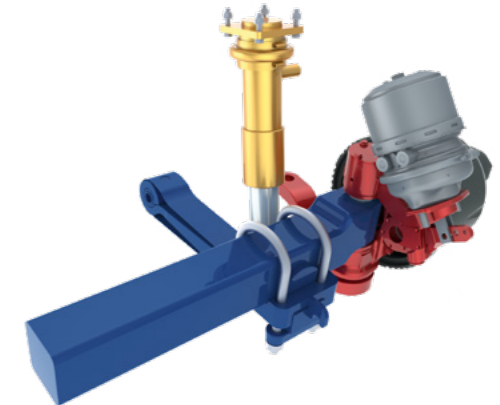

MACPHERSON AXLE TECHNOLOGY

»MPA«

The axle is extremely maintenance friendly due to the small number of components. In addition, it is designed for high payloads.

- » Maximum steering angle 60°
- » Axle stroke 350 mm
- » Loading height 785 mm



THE ALL-PURPOSE WEAPON

Our semi lowloaders of the »ARCUS« family are real workhorses - there is nothing they cannot handle in the payload class up to 130 t. The »ARCUS« family impresses with an innovative steering system. In combination with the extremely low loading height of just 790 mm, it provides you with the decisive advantage in terms of maneuverability, performance and efficiency.



OPTIMUM STEERING*

- + Ideal cornering characteristics and optimum adaptation of the steering to each extension stages by utilizing the combination of friction and positively steered pendular axles
- + No manual adjustment of the steering of the rear chassis is required for the different extension stages
- + Exact maneuvering and reverse driving due to automatic conversion to a forced steered system

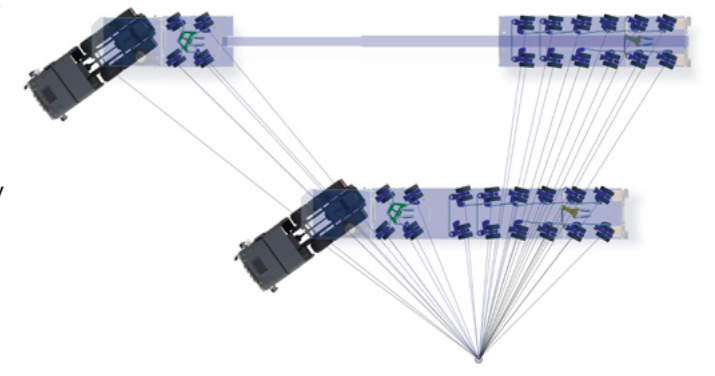

Exemplary representation

* in combination with »SmartControl«

SIMPLE OPERATION

The Goldhofer »SmartControl« enables the operation of many functions of a semi-trailer vehicle at the push of a button, from starting up the traction unit to the electronic tracking aid and up to, and including, saving and adjustment of different driving heights.



All »SmartControl« functions can also be actuated by using the operating panels on the gooseneck and chassis.



SOPHISTICATED DESIGN FRICTION STEERED PENDULAR AXLE

In addition to reducing the number of components which are required, our new pendular axle particularly provides you with an advantage in terms of efficiency. The new friction-steered axle unit significantly reduces tire wear and puts significantly less strain on all components.

- » Maximum steering angle 65°

STANDARD TIRES

- » Axle stroke 600 mm
- » Loading height 790 mm

»CARGOPLUS«

- » Axle stroke 500 mm
- » Loading height 735 mm



STZ-L | STZ-H | »MPA« UP TO ANY TASK

YOUR BENEFITS

- ✓ Rigid and robust vehicle frame
- » Durability and reliability
- ✓ Continuous steel loading area with anti-slip coating
- » Flexible loading capability with higher working safety
- ✓ Proven and precise Goldhofer steering system
- » Low maintenance costs and reduced tire wear

TECHNICAL FEATURES

- + Tires

| | |
|------------------|---------------|
| Standard | 245/70 R 17.5 |
| »CARGOPLUS« 60 | 205/65 R 17.5 |
| (only for STZ-L) | 205/65 R 17.5 |
- + Vehicle width

| | |
|---------------|--------------------------------|
| STZ-L STZ-H | 2,550 mm / 2,750 mm / 3,000 mm |
| »MPA« | 2,550 mm / 2,750 mm |
- + Axle spacing

| | |
|--|---------------------|
| | 1,360 mm / 1,510 mm |
|--|---------------------|



**LOW MAINTENANCE
VEHICLE DESIGN**



LOW TIRE WEAR



**COMPRHENSIVE
ACCESSORIES**



SEMI LOWLOADER



GOOSENECK



- + Fifth wheel load 20-35 t
- + Swing clearance radius 2,100-2,800 mm
- + Fixed/hydraulic
- + Outside position beams

EXTENSION STAGES



- + Rigid
- + Single telescopic
- + Double telescopic

REAR BOGIE

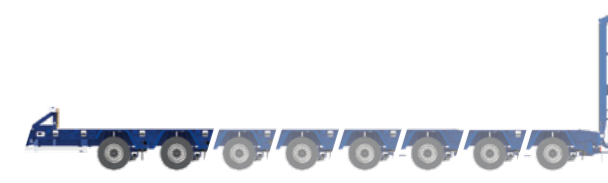

- + Width excavator trough*
 - STZ-L: 754 mm / 1954 mm / 1,104 mm
 - »MPA«: 604 mm / 804 mm
- + Number of axles
 - STZ-L: 2-6
 - STZ-H: 4-8
 - »MPA«: 2-8

*Depending on vehicle width

TECHNICAL DIFFERENCES

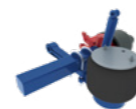

STZ-L

- + Axle load (depending on country-related regulations) 10-12 t at 80 km/h
- + Axle load (technical) 15.6 t at 20 km/h
- + Loading height 785 mm / 710 mm**
- + Axle stroke 200 mm
- + Maximum steering angle 45°



STZ-H

- + Axle load (depending on country-related regulations) 10-12 t at 80 km/h
- + Axle load (technical) 15.6 t at 20 km/h
- + Loading height 800 mm
- + Axle stroke 260 mm
- + Maximum steering angle 45°



»MPA«

- + Axle load (depending on country-related regulations) 12 t at 80 km/h
- + Axle load (technical) 15.6 t at 20 km/h
- + Loading height 785 mm
- + Axle stroke 350 mm
- + Maximum steering angle 60°

**Depending on tires

STZ-L | »MPA« WITH WHEEL RECESS FLEXIBILITY COUNTS

YOUR BENEFITS

- ✓ Varied application possibilities for the most different loads
- » Increased flexibility in action
- ✓ Long excavator trough deck and low wheel recesses
- » Lowest loading heights to fulfill the most stringent height guidelines
- ✓ Intelligent system for covering the recesses
- » Reduced set-up time for the most varied loads

TECHNICAL FEATURES

- + Axle load *(depending on country-related regulations)* 10-12 t at 80 km/h
- + Tires 245/70 R 17.5
- + Vehicle width 2,550 mm / 2,750 mm
- + Axle spacing 1,360 mm



**FLEXIBLE USE
OF THE LOADING
PLATFORM**



**SIMPLE
OPERATION**



**PRACTICAL
LASHING CONCEPT**



SEMI LOWLOADER WITH WHEEL RECESS



GOOSENECK



- + Fifth wheel load 20-26 t
- + Swing clearance radius 2,100-2,800 mm
- + Fixed
- + Outside position beams

BOGIE WITH WHEEL RECESS



- + Width excavator trough*
STZ-L: 754 mm/954 mm
»MPA«: 604 mm/804 mm
- + Number of axles 3-5

*Depending on vehicle width

TECHNICAL DIFFERENCES

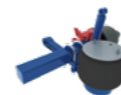

STZ-L WITH WHEEL RECESS

- + Axle load *(depending on country-related regulations)* 10-12 t at 80 km/h
- + Axle load *(technical)* 15.6 t at 20 km/h
- + Loading height 785 mm
- + Axle stroke 200 mm
- + Maximum steering angle 45°



»MPA« WITH WHEEL RECESS

- + Axle load *(depending on country-related regulations)* 12 t at 80 km/h
- + Axle load *(technical)* 15.6 t at 20 km/h
- + Loading height 785 mm
- + Axle stroke 350 mm
- + Maximum steering angle 60°

»ARCUS« P

»ARCUS« PK

YOUR BENEFITS

- ✓ Combination of friction and forced steered pendular axles
- » Improved cornering characteristics and optimum adaptation of the steering to every extension stage*
- ✓ Goldhofer »SmartControl«
- » Highest possible user-friendliness
- ✓ Extremely low loading height of just 735 mm**
- » Transportation of high load

TECHNICAL FEATURES

- + Axle load
(depending on country-related regulations)
(technical) 12 t at 80 km/h
14 t at 25 km/h
- + Loading height 735 mm / 800 mm**
- + Axle stroke 500 mm / 600 mm**
- + Tires Standard 245/70 R 17.5
»CARGOPLUS« 80 225/65 R 17.5
- + Axle spacing 1,510 mm

* in combination with »SmartControl«
** depending on tires



OPTIMUM STEERING



SIMPLE OPERATION



EXTREMELY LOW LOADING HEIGHT



ARCUS



SEMI LOWLOADER

»ARCUS« PK

»ARCUS« P



COMBINATIONS

Thanks to a wide range of possible combinations and extensive accessories, the »ARCUS« family can be flexibly adapted to any transport situation.

GOOSENECK



- + Fifth wheel load
»ARCUS« P 20-35 t
»ARCUS« PK 26-35 t
- + Swing clearance radius
2,100-2,800 mm
- + Fixed/hydraulic
- + Center beam,
Outside position beam

FRONT BOGIE (only »ARCUS« PK)



- + Number of axles
2-3
- + Maximum steering
angle 65°

EXTENDA- BILITY



- + Fixed, 1 or 2

REAR BOGIE



- + Vehicle width:
»ARCUS« P 2,550 mm/2,750 mm/3,000 mm
»ARCUS« PK 2,750 mm/3,000 mm
- + Width excavator trough*
640 mm/840 mm/1,090 mm
- + Number of axles
»ARCUS« P 3-8
»ARCUS« PK 4-8
- + Maximum steering angle 60°

*Depending on vehicle width



THE »ARCUS« PK ENABLES DRIVING EMPTY WITHOUT A CO-DRIVER.

Loading the front bogie onto the loading area of the rear bogie works with the help of the Goldhofer »SmartControl« without additional personnel or aids.



STZ-L | »MPA« WITH WHEEL RECESS

TECHNICAL DATA

| | »MPA« WITH WHEEL RECESS | STZ-L WITH WHEEL RECESS |
|--|--|---|
| Axle load <i>(depending on country-related regulations)</i> <i>(technical)</i> | 10-12 t at 80 km/h 15.6 t at 20 km/h | 10-12 t at 80 km/h 15.6 t at 20 km/h |
| Fifth wheel load | 20-26 t | 20-26 t |
| Loading height | 785 mm | 785 mm |
| Axle stroke | 350 mm | 200 mm |
| Tires | 245/70 R 17.5 | 245/70 R 17.5 |
| Vehicle width | 2,550 mm 2,750 mm | 2,550 mm 2,750 mm |
| Axle spacing | 1,360 mm | 1,360 mm |
| Maximum steering angle | 60° | 45° |
| Width excavator trough* | 604 mm 804 mm | 754 mm 954 mm |
| Number of axles | 3-5 | 3-5 |
| Surface platform refinement | Durability ensured with high-quality finish with zinc-dust base coat | |



STZ-L | »MPA« WITH WHEEL RECESS

*Depending on the vehicle width



STZ-L | STZ-H »MPA«

TECHNICAL DATA

| | STZ-L | STZ-H | »MPA« |
|--|--|---|--------------------------------------|
| Axle load <i>(depending on country-related regulations)</i> <i>(technical)</i> | 10-12 t at 80 km/h 15.6 t at 20 km/h | 10-12 t at 80 km/h 15.6 t at 20 km/h | 12 t at 80 km/h 15.6 t at 20 km/h |
| Fifth wheel load | 20-35 t | 20-35 t | 20-35 t |
| Loading height | 785 mm ^[1] 710 mm ^[2] | 800 mm | 785 mm |
| Axle stroke | 200 mm | 260 mm | 350 mm |
| Tires | | | |
| Standard | 245/70 R 17.5 205/65 R 17.5 | 245/70 R 17.5 | 245/70 R 17.5 |
| »CARGOPLUS« 60 | 205/65 R 17.5 | | |
| Vehicle width | 2,550 mm 2,750 mm 3,000 mm | 2,550 mm 2,750 mm 3,000 mm | 2,550 mm 2,750 mm |
| Axle spacing | 1,360 mm/1,510 mm | 1,360 mm/1,510 mm | 1,360 mm/1,510 mm |
| Maximum steering angle | 45° | 45° | 60° |
| Width excavator trough* | 754 mm 954 mm 1,104 mm | | 604 mm 804 mm |
| Number of axles | 2-6 | 4-8 | 2-8 |
| Surface platform refinement | Durability ensured with high-quality finish with zinc-dust base coat | | |



STZ-L | STZ-H | »MPA«

*Depending on the vehicle width
^[1] Tires 245/70 R 17,5
^[2] Tires 205/65 R 17,5 and 205/65 R 17,5 (CP60)

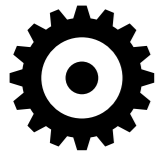

»ARCUS« P »ARCUS« PK

TECHNICAL DATA

| | »ARCUS« P | »ARCUS« PK |
|--|--|------------------------------------|
| Axle load <i>(depending on country-related regulations)</i> <i>(technical)</i> | 12 t at 80 km/h 14 t at 25 km/h | 12 t at 80 km/h 14 t at 25 km/h |
| Fifth wheel load | 20-35 t | 26-35 t |
| Loading height | 735 mm/800 mm* | 735 mm/800 mm* |
| Axle stroke | 500 mm/600 mm* | 500 mm/600 mm* |
| Tires | 245/70 R 17.5 »CARGOPLUS« 80 225/60 R 17.5 | 245/70 R 17.5 225/60 R 17.5 |
| Vehicle width | 2,550 mm/2,750 mm/3,000 mm | 2,750 mm/3,000 mm |
| Axle spacing | 1,510 mm | 1,510 mm |
| Maximum steering angle | 60° | Front bogie 65° Rear bogie 60° |
| Width excavator trough** | 640 mm/840 mm/1,090 mm | 840 mm/1,090 mm |
| Number of axles | 3-8 | Front bogie 2-3 Rear bogie 4-8 |
| Surface platform refinement | Durability ensured with high-quality finish with zinc-dust base coat | |

*Depending on tires
**Depending on vehicle width

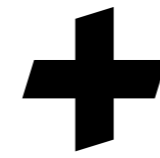

STZ-L | STZ-H | »MPA« »ARCUS« PK

ACCESSORIES AND OPTIONS

GENERAL ACCESSORIES

- + Knorr "TIM"/Wabco »Smartboard«
- + »easyCONTROL« remote steering
- + »SmartControl«
- + Wide load marker boards
- + Storage boxes under the loading platform
- + Working lights
- + Lift axle

GOOSENECK

- + Spare wheel carrier
- + High front wall
- + Sidewalls
- + Premium tool box
- + Loading ramp
- + Cable winch
- + Stowage aids for accessories
- + Electrohydraulic or diesel power pack

LOADING PLATFORM

- + Long material trestle, stake pocket strip
- + Outriggers
- + Threaded bushes
- + Load-securing trestle
- + Excavator crawler deck
- + Sliding table
- + Insertable wheel recesses

REAR

- + Various rear designs, suspension rail
- + Hydraulic ramp sideshift
- + Climbing pads
- + Mechanical/hydraulic landing legs
- + Detachable ramps
- + Ramps in a variety of widths, lengths and coverings



CONTACT TRANSPORT TECHNOLOGY

GOLDHOFER AKTIENGESELLSCHAFT

Donaustrasse 95, 87700 Memmingen/Germany
Tel.: +49 8331 15-0, Fax: +49 8331 15-239
Web: www.goldhofer.com, E-Mail: info@goldhofer.com

SALES

Telephone Sales Europe: +49 8331 15-341
Telephone Sales International: +49 8331 15-342
E-Mail: sales-transporttechnology@goldhofer.com

SERVICES AND SPARE PARTS

Telephone: +49 8331 15-400, Fax: +49 8331 15-247
Emergency Hotline: +49 172 837 61 65
E-Mail: service-transporttechnology@goldhofer.com